

***To arrange a viewing contact us
today on 01268 777400***

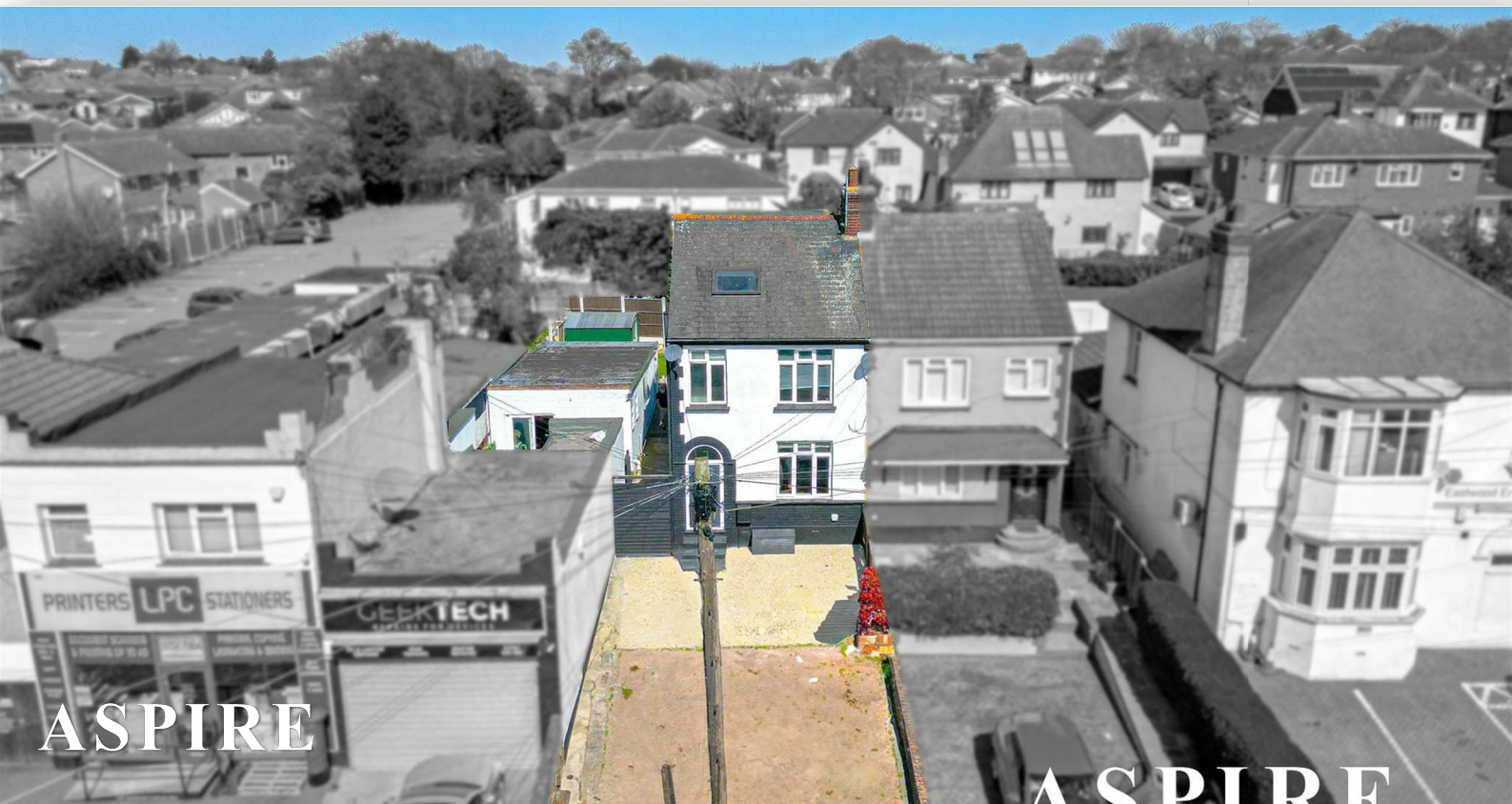

Rayleigh Road, Leigh-On-Sea Guide price £400,000

GUIDE PRICE £400,000 - £425,000

Aspire Estate Agents are delighted to present this spacious and beautifully maintained four-bedroom semi-detached family home, ideally located in the heart of Eastwood. Set over three floors, the property features a bright lounge with feature fireplace, a stunning modern kitchen/diner with integrated appliances, a conservatory, and a ground floor WC. Upstairs offers four well-proportioned double bedrooms and a family bathroom. The generous rear garden includes a workshop and garden room with shower and W/C perfect for a home office, or studio. The front provides ample off-street parking for several vehicles.

Perfectly positioned close to Eastwood Park, Cherry Orchard Country Park, excellent schools including Heycroft Primary and The Eastwood Academy, and local shops and eateries, this home offers convenience for both families and commuters. With easy access to the A127, nearby bus routes, and train connections to Southend and Rayleigh, this is a rare opportunity to secure a versatile and well-presented family home in a highly sought-after location.

www.aspireestateagents.co.uk

Entrance Hall

Lounge

12'0" x 12'0" (3.68 x 3.68)

Kitchen/Diner

16'4" x 11'1" (4.98 x 3.38)

Conservatory

13'5" x 9'10" (4.09 x 3.00)

W/C

Landing

Bedroom

11'8" x 9'10" (3.58 x 3.00)

Bedroom

11'1" x 9'10" (3.38 x 3.00)

Bathroom

Landing

Bedroom

13'8" x 6'5" (4.19 x 1.98)

Bedroom

11'1" x 8'2" (3.38 x 2.49)

Garden

Office

13'8" x 11'8" (4.19 x 3.58)

Workshop

18'0" x 13'8" (5.49 x 4.19)

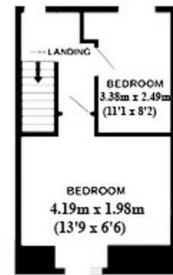
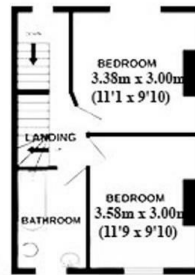
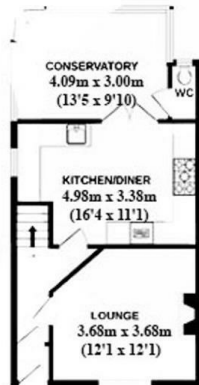
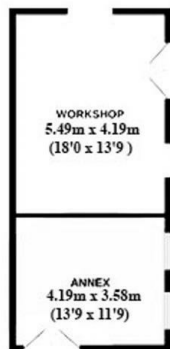

ASPIRE
ESTATE AGENTS
RAYLEIGH ROAD
EASTWOOD/LEIGH-ON-SEA
🚗 x4 🚲 x2

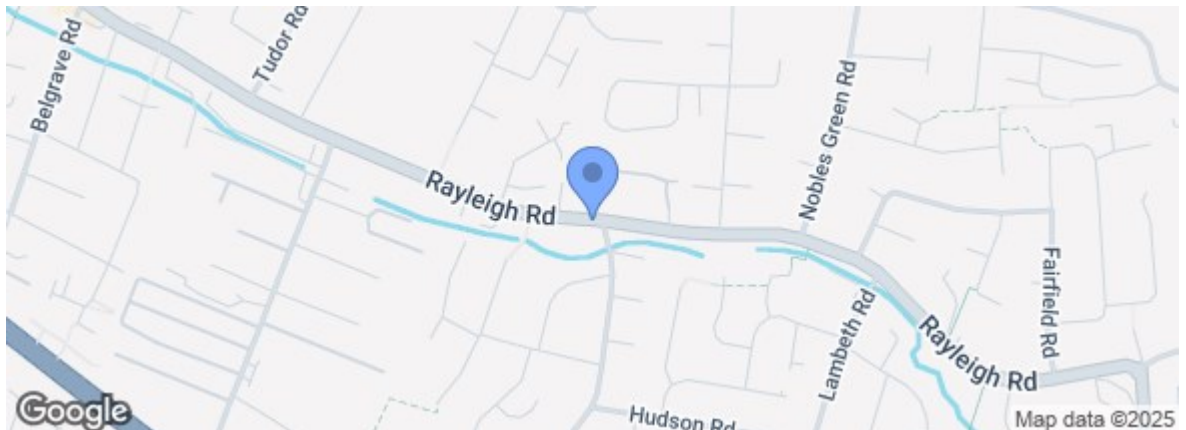
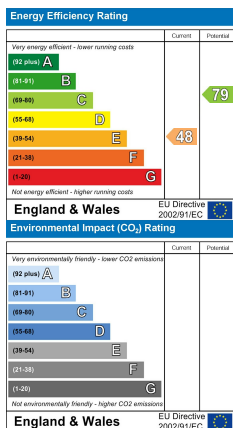

rightmove.co.uk
The UK's number one property website

Zoopla.co.uk

Under the Property Misdescriptions Act 1991 we make every effort to ensure our sales details are accurate but they are a general outline and do not constitute any part of an offer or contract. Any services, equipment and fittings have not been tested and no warranty can be given as to their condition. We strongly recommend that all the information provided be verified by your advisors and in particular, measurements required for a specific purpose such as fitted furniture or carpets. Please tell us if you have any problems and members of our branches will help either over the phone or in person. A copy of our complaints procedure is available on request. The details are issued on the strict understanding that any negotiations in respect of the property named herein are conducted through Aspire Estate Agents.